

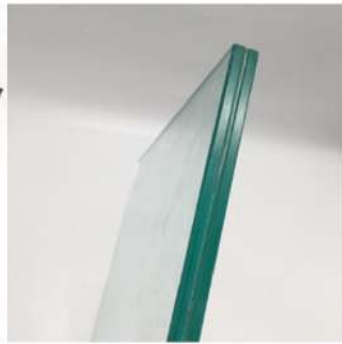

**Single glass**



**Double glazed**



**Laminated glass**

# C60 FIXED WINDOW

## PRODUCT BRIEF INTRODUCTION



### Features & Benefits

- 60mm X 20mm Frame.
- Architectural Applications.
- Supports Single Glazing.

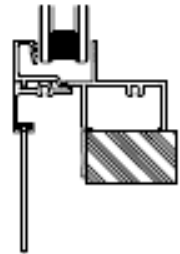
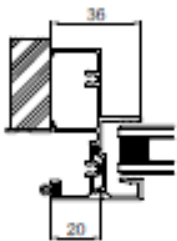
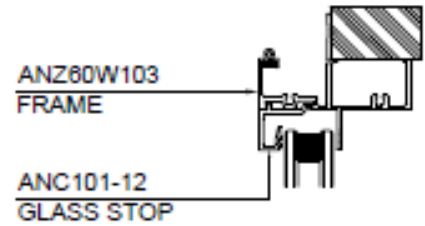

### GLAZING DETAILS

#### DOUBLE GLAZING

•Clear Glazing:  
5Clr /9Ar/ 5Clr  
6Clr /9Ar/ 6Clr

•Obscure Glazing:  
5Obs /9Ar/ 5Clr  
6Obs /9Ar/ 6Clr

•Low-E Glazing:  
5Low-E /9Ar/ 5Clr  
6Low-E /9Ar/ 6Clr

•Laminated Glazing:  
9.14mm  
11.14mm

#### SINGLE GLAZING

•Clear Glazing:  
5Clr,6Clr

•Obscure Glazing:  
5Clr,6Clr

### COMPATIBLE WITH

- C60 Awning Window

### PRODUCT SPECS

#### Max.Recommended Sizes

- Height: 2000
- Width: 1300

#### Max.Product Performance

- Water (PA): 300 Pa

# C60 AWNING WINDOW

## PRODUCT BRIEF INTRODUCTION

